

wiper A63

seal spec

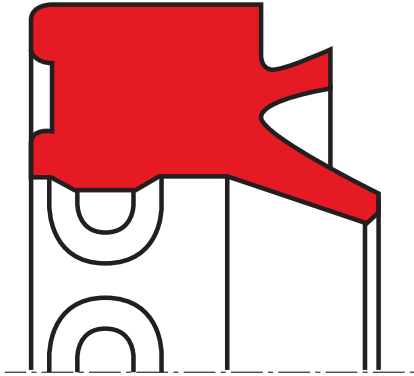

description

dirt wiper with additional static sealing lip and bearing segments; sealing edge of wiper lip slightly rounded.

application



not bolded symbols; please consult our technical for application limitations

category of profile

machined or molded/standard/trade product.

single acting

area of application: hydraulics

earth moving equipment, agricultural machinery, injection moulding machines, telescopic cylinders, presses, industrial vehicles, cranes, mining, loading platforms, support cylinders.

operating parameters & material

material	temperature	running surface speed
s-mart PU (95 shore A)	-30 °C ... +110 °C	2 m/s

the stated operation conditions represent general indications. it is recommended not to use all maximum values simultaneously. surface speed limits apply only to the presence of adequate lubrication film.

surface quality

surface roughness	Rtmax (µm)	Ra (µm)
sliding surface	according to seal data	
bottom of groove	≤6,3	≤1,6
groove face	≤15	≤3

tolerance recommendation

seal housing tolerances		cs	R [mm]
ØD	H11	≤ 5	max. 0,3
ØD1	H11	>5.....≤ 7,5	max. 0,4
		>7,5.....≤ 10	max. 0,6
		> 10	max. 0,8

fitting & installation

careful fitting is a prerequisite for the correct function of the A64. generally, wipers can be quickly and easily fitted by deforming into a kidney shape.

**lead-in chamfers**

length and angle are to be designed to suit the rod seal used.

seal & housing recommendations

please note that we are able to produce those profiles to your specific need or any non standard housing. for detail measurements, please see seal-mart catalog...

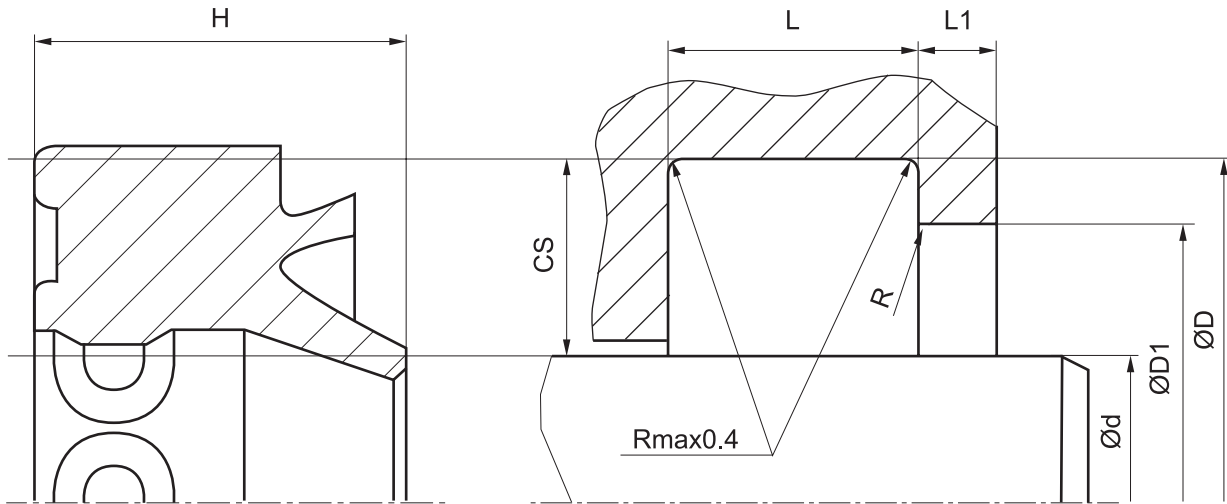

don't hesitate to contact our technical department for further information or for special requirements (temperature, speed etc.), so that suitable materials and/or designs can be recommended.